

# #14419 City Street Corner Kit

## Step-by-step assembly instructions

Copyright miniatures.com 2024

### PARTS LIST:

Platform Base  
Platform Shortest Side  
Platform Short Side  
Platform Long Side (2)  
Platform Longest Side  
Platform Floor  
Storm Drain Trim  
Storm Drain Grate  
Wall (4)  
Wall Side (4)  
Wall Top (2)  
Column Side A (6)  
Column Side B (6)  
Column Top (3)  
Column Cap (3)  
Column Bevel (3)  
Fence (2)

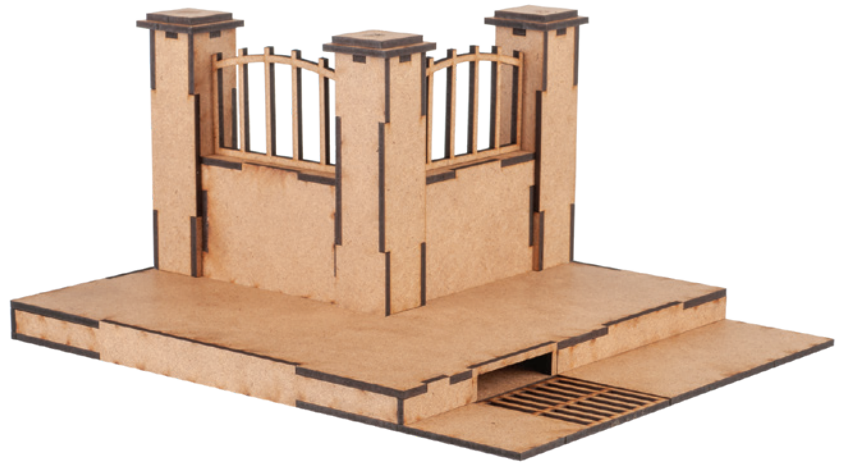

### GENERAL INSTRUCTIONS

- Identify and inspect all parts using the Parts List.
- Thoroughly read the directions before starting.
- Set up a dedicated work area to avoid the need to unpack, repack, or move the project frequently.
- Use a clean, level, and dry work surface protected from glue spills.
- Dry fit the parts using masking tape to ensure everything aligns correctly before permanent assembly.

## Assembly Instructions

### PLATFORM

*Parts you will need:*

- Platform Base
- Platform Shortest Side
- Platform Short Side (2)
- Platform Long Side (2)
- Platform Longest Side
- Platform Floor
- Storm Drain Trim
- Storm Drain Grate

1. Place the **Base** flat on the work surface, so that the rectangular slots are towards the right
2. Glue the **Shortest Side** into the smallest slot at the front-right corner.
3. Glue the **Short Side** into the other slot at the back-right corner.
4. Glue the two **Long Sides** to the front and back edges of the **Base**. A tab on the **Long Side** will meet a slot on the **Base**.
5. Glue the **Longest Side** to the left edge of the **Base**.
6. Glue the **Floor** to the top of the assembly while aligning the tabs and slots.
7. Glue the **Storm Drain Trim** in place. It goes into the remaining opening along the side.
8. Place the **Storm Drain Grate** into the square opening. It can remain removable.
9. Put the assembly aside to dry.

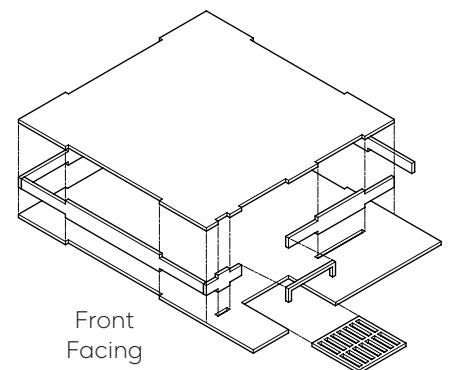

### WALLS

*Parts you will need:*

- Wall (4)
- Wall Side (4)
- Wall Top (2)

10. Place a **Wall** flat on the work surface.
11. Glue both **Wall Sides** to the short edges of the **Wall**.
12. Glue **Wall Top** to the long edge of the **Wall** that has the tab.
13. Glue the other **Wall** on top of the assembly. Orient it so that the tabs and slots match.
14. Let dry.
15. Repeat steps 10-14 for the second wall assembly.

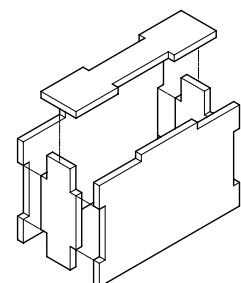

## COLUMNS

Parts you will need:

- Column Side A (6)
- Column Side B (6)
- Column Top (3)
- Column Cap (3)
- Column Bevel (3)

- Place a **Side A** flat on the work surface. Notice it has a notch at one end.
- Glue a **Side B** to each long edge of **Side A**. Make sure to orient the end notches in the same direction.
- Glue a **Top** into the end notches.
- Glue a second **Side A** on top of the assembly.
- Let the glue set for a few minutes.
- Stand the column up with the **Top** facing up.
- Glue a **Cap** on top of the column and centered.
- Glue a **Bevel** on top of the column and centered.
- Let dry.
- Repeat steps 16-23 to assemble two more columns.

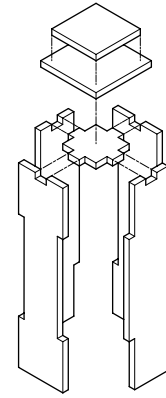

## PUTTING IT TOGETHER

Parts you will need:

- Fence (2)

- Glue the wall assemblies between the column assemblies in a desired configuration.
- Glue a **Fence** on top of a wall and between the column assemblies.
- Repeat Step 27 for the other **Fence**.
- Place this completed wall assembly on top of the platform assembly. It can remain removable.

Assembly of the City Street Corner Kit is now complete. Enjoy finishing it as desired.

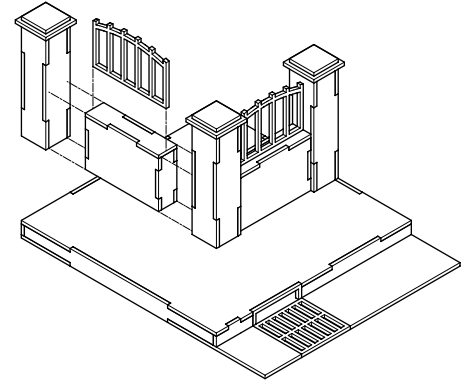

## Parts Diagram

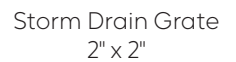
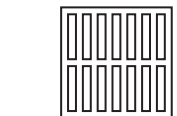
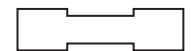
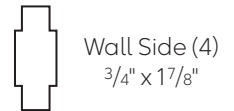
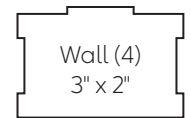
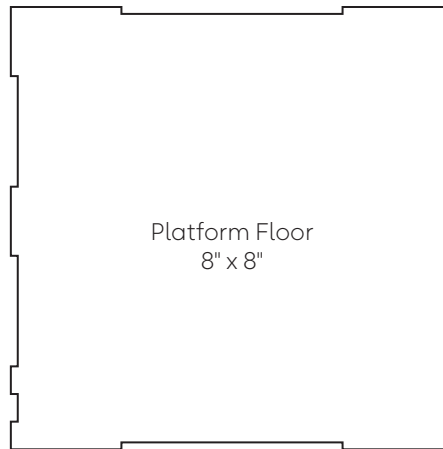
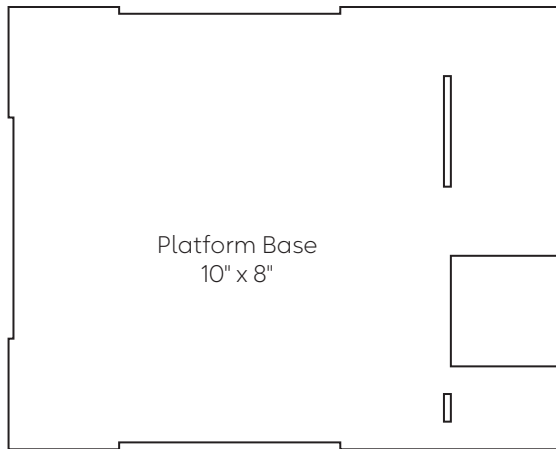

Platform Longest Side  
8" x 5/8"



Platform Long Side (2)  
7 3/4" x 5/8"



Platform Short Side  
4 1/2" x 5/8"



Platform Shortest Side  
1 1/2" x 5/8"



Column Side A (6)  
1" x 4"



Column Side B (6)  
1" x 4"



Column Cap (3)  
1 1/4" x 1 1/4"



Column Bevel (3)  
1" x 1"



Column Top (3)  
1" x 1"